

THIS DRAWING IS UNPUBLISHED. RELEASED FOR PUBLICATION, 19  
 © COPYRIGHT 19 BY AMP INCORPORATED. ALL INTERNATIONAL RIGHTS RESERVED.

LOC	DIST	P	F	REVISIONS			DATE	APPD
G	14			ZONE	LTR	DESCRIPTION		
					B	REV / 0G10-0019-99	07APR99	ME SB

1 STAMP 85 AMP 22-18\* APPROX AS SHOWN  
 22-16 TERMINALS ARE STAMPED 22-18 IN  
 ACCORDANCE WITH MILITARY SPEC MIL-T-7928  
 COMMERCIAL WIRE RANGE IS 22-16

2 WIRE INSULATION DIA: 2.67-3.56 [.105-.140]

3 TONGUE MATERIAL THK:  $0.79 \pm 0.05$  [ $.031^{+.002}$ ]

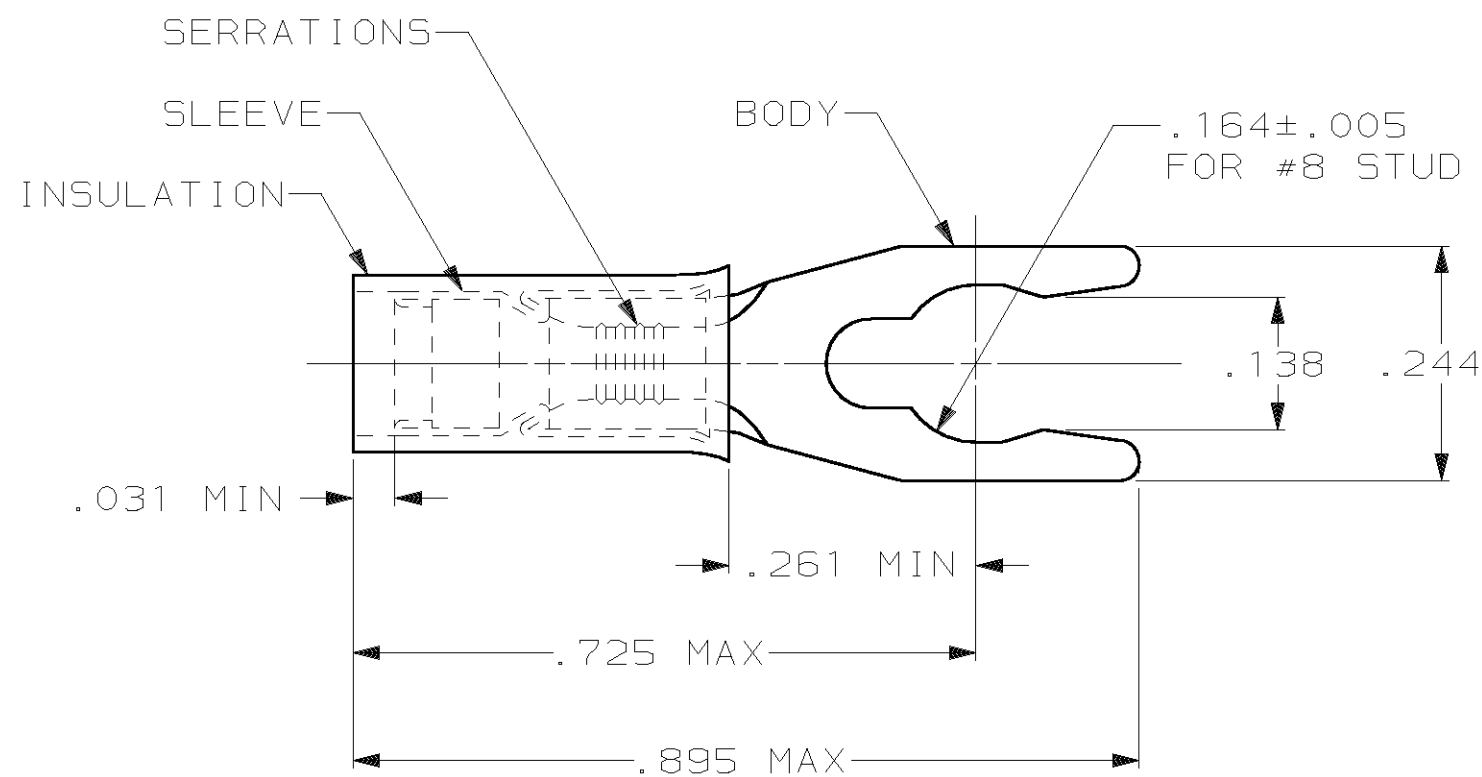

5000	ON TAPE, REEL	55768-1
QUANTITY	PACKAGE TYPE	PART NO

DO NOT SCALE PRINT. UNLESS SPECIFIED DIMENSIONS IN INCHES TOLERANCES ON: 2 PLC DEC ± - 3 PLC DEC ± .008 ANGLES ± - MATERIAL BODY: PHOS BRZ PER ASTM B 139 SLEEVE: COPPER PER ASTM B 152 INSULATION: NYLON, COLOR, RED FINISH BODY & SLEEVE: TIN PL PER ASTM B 545	DR 8/31/88 MS FEHER	<b>AMP</b> AMP INCORPORATED Harrisburg, Pa. 17105	
	CHK 9/1/88 JR RUTH		
	APPD 9/1/88 G YETTER	TERMINAL, SPRING SPADE, PIDG™, WIRE SIZE, 22-16 AWG	
	APPD 9/1/88 L DINGER	PRODUCT SPEC	SIZE
APPLICATION SPEC	-	<b>B</b>	00779
WEIGHT -	-	SCALE	5:1
		DRAWING NO	55768
		SHEET	1 OF 1